

Project: \_\_\_\_\_

Fixture Type: \_\_\_\_\_ Quantity: \_\_\_\_\_

Customer: \_\_\_\_\_

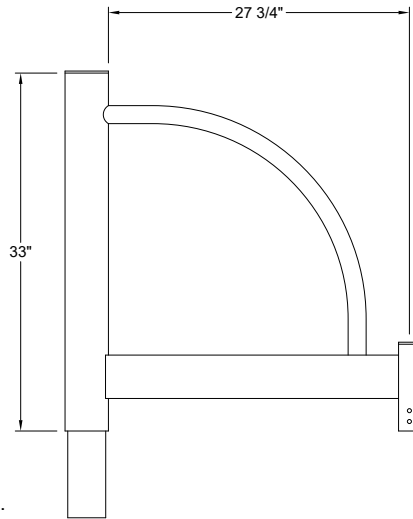
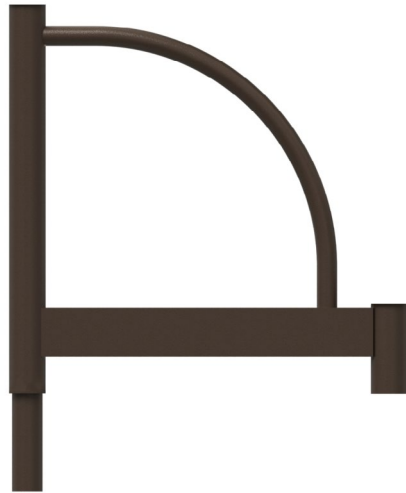

**Specifications**

**Material:**  
Durable A356 cast aluminum, 6061 extruded aluminum and sheet metal. Hardware is stainless steel or zinc plated steel.

**Fixture Mounting:**  
Dual clevis pins to tenon which aid in hang-straight, plus two locking set screws.

**Post Arm Mounting:**  
Reverse tenon with set screws in upper portion of pole.

Minimum wall thickness for corresponding pole is 0.188" (3/16") for aluminum and 0.1793 (7ga) for steel.

Slip-over available for any pole, consult factory. Pole section of arm matches pole diameter and style (smooth or fluted).

**Electrical:**  
Post arms are prewired with 14ga line Voltage & 18ga dimming leads.

**Finish:**  
A polyester powder coat high quality finish. Marine grade finish is available.

**Modifications:**  
Consult factory for custom or modified designs.

**Buy American:**  
This product is assembled in the USA and meets the Buy America(n) government procurement requirements under FAR, DFARS, and DOT regulations. [Click here for additional information.](#)

**PA045 - POST ARM**

Extruded aluminum post arm for pendant luminaire.

|               | EPA  | Weight    |
|---------------|------|-----------|
| PA045-3-1-N-3 | 1.95 | 16.5 lbs. |
| PA045-3-1-N-4 | 2.14 | 17.0 lbs. |
| PA045-3-1-N-5 | 2.34 | 17.5 lbs. |
| PA045-3-1-N-6 | 2.53 | 18.0 lbs. |
| PA045-3-2-N-3 | 3.30 | 33.5 lbs. |
| PA045-3-2-N-4 | 3.50 | 34.0 lbs. |
| PA045-3-2-N-5 | 3.70 | 34.5 lbs. |
| PA045-3-2-N-6 | 3.89 | 40.0 lbs. |

**Catalog Logic**

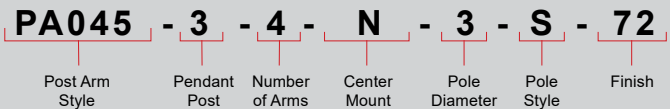

**Catalog Number**

PA045

1

3

2

3

N

4

5

6

**1 Arm Configuration**



**2 Arm Configuration**

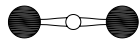

**3 Arm Configuration**

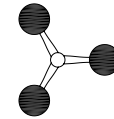

**4 Arm Configuration**

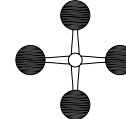

| 1 | POST ARM ORIENTATION |
|---|----------------------|
| 3 | Pendant              |

| 2 | NUMBER OF ARMS          |
|---|-------------------------|
| 1 | One Arm Configuration   |
| 2 | Two Arm Configuration   |
| 3 | Three Arm Configuration |
| 4 | Four Arm Configuration  |

| 3 | CENTER MOUNT OPTIONS |
|---|----------------------|
| A | Center Mount         |
| N | No Center Mount      |

| 4 | POLE DIAMETER            |
|---|--------------------------|
| 3 | 3 - 3 Inch               |
| 4 | 4 - 4 Inch               |
| 5 | 5 - 5 Inch               |
| 6 | 6 - 6 Inch (Smooth only) |

| 5 | POLE STYLE |
|---|------------|
| S | Smooth     |
| F | Fluted     |

| 6 FINISHES   |                |               |                               |                |               |
|--|----------------|---------------|-------------------------------|----------------|---------------|
| *Premium and Marine Grade Finish have additional charges |                |               |                               |                |               |
| Standard Colors  | Standard Grade | Marine Grade* | Standard Colors               | Standard Grade | Marine Grade* |
| Aspen Green  | 10             | 10M           | Copper Clay                   | 53             | 53M           |
| Cantaloupe   | 11             | 11M           | Silver                        | 56             | 56M           |
| Lilac  | 12             | 12M           | Black Verde                   | 61             | 61M           |
| Putty  | 13             | 13M           | Painted Chrome                | 70             | 70M           |
| Raw Unfinished   | 40             | NA            | Painted Copper                | 71             | 71M           |
| Black  | 41             | 41M           | Textured Black                | 72             | 72M           |
| Forest Green   | 42             | 42M           | Matte Black                   | 73             | 73M           |
| Bright Red   | 43             | 43M           | Textured Architectural Bronze | 76             | 76M           |
| White  | 44             | 44M           | Textured White                | 77             | 77M           |
| Bright Blue  | 45             | 45M           | Textured Silver               | 78             | 78M           |
| Sunny Yellow   | 46             | 46M           | PREMIUM FINISH                | Premium Grade* | Marine Grade* |
| Aqua Green   | 47             | 47M           | Textured Desert               | 80             | 80M           |
| Galvanized   | 49             | NA            | Graystone                     | 82             | 82M           |
| Navy   | 50             | 50M           | Oil Rubbed Bronze             | 83             | 83M           |
| Architectural Bronze                                     | 51             | 51M           | Carbon Graphite               | 96             | 96M           |
| Patina Verde   | 52             | 52M           |                               |                |               |

Consult Factory for additional paint charges and availability.

Project: \_\_\_\_\_

Fixture Type: \_\_\_\_\_ Quantity: \_\_\_\_\_

Customer: \_\_\_\_\_



**FINISHES COLORS**

| STANDARD |                |        |                |                    |       |                 |                |             |       |             |              |              |            |             |             |      |              |            |       | PREMIUM    |                |             |                      |                               |                 |         |                   |                 |
|----------|----------------|--------|----------------|--------------------|-------|-----------------|----------------|-------------|-------|-------------|--------------|--------------|------------|-------------|-------------|------|--------------|------------|-------|------------|----------------|-------------|----------------------|-------------------------------|-----------------|---------|-------------------|-----------------|
| WHITE    | TEXTURED WHITE | SILVER | PAINTED CHROME | PAINTED GALVANIZED | PUTTY | TEXTURED SILVER | TEXTURED BLACK | MATTE BLACK | BLACK | BLACK VERDE | PATINA VERDE | FOREST GREEN | AQUA GREEN | ASPEN GREEN | BRIGHT BLUE | NAVY | SUNNY YELLOW | CANTALOUPE | LILAC | BRIGHT RED | PAINTED COPPER | COPPER CLAY | ARCHITECTURAL BRONZE | TEXTURED ARCHITECTURAL BRONZE | TEXTURED DESERT | GRANITE | OIL RUBBED BRONZE | CARBON GRAPHITE |

**FINISHES**

- A polyester powder coat high quality finish is electro-statically applied and baked at 430°F for exceptional durability and color retention. Products undergo an intensive five-step cleansing and pretreatment process for maximum paint adhesion.
- Marine grade finish provides superior salt, humidity and UV protection. This coating withstands up to 3,000 hours of continuous salt spray, comes with a 5-year warranty and is available in either a textured or gloss surface.

**WARRANTY**

See [www.ANPlighting.com](http://www.ANPlighting.com) for complete fixture warranty.

**LED warranty information**

- 5 year limited warranty\*
- \*Limited Warranty: A typical year is defined as 4,380 hours of operation.